



conference pack 2010

An excellent, award winning, modern hotel with a warm welcome, comfortable surroundings and a dedicated approach to customer service; The Draycote Hotel situated in Shakespeare's county of Warwickshire, nestling in the heart of England and is highly deserving of its reputation as one of the areas most outstanding hotels and golf courses. Bright, contemporary design and exceptional facilities create a place to stay that is friendly and informal.

The location of the Draycote Hotel, accessible from all Midlands motorway networks and airports, makes it an ideal venue for business meetings and corporate events. This, coupled with extensive parking facilities, ensures seamless arrival and departure from anywhere in the country.

At the Draycote we offer superb conference and business facilities in a light contemporary environment. With an excellent range of conference suites and meeting rooms our venue is ideal for, product launches, residential training courses, golf days & team building exercises, also private dining, award dinners, weddings, celebrations and private parties.

Whether you are organising a small conference or a large meeting for 250 people, our flexible facilities and exceptional customer service guarantee the success of your event.

Our conference and events brochure contains information and suggestions to help you plan your day. Be assured our experienced events management team will be on hand to tailor your event to meet any special requirements. Our conference coordinator will be happy to discuss the extensive options that the Draycote Hotel can offer, at any stage during the planning of your event.

After a productive day achieving results, make use of our post-work wind downs to refresh you and lift your spirits further, enjoy a complimentary round of golf. (Tee off after 5.00pm subject to availability and must be booked in advance). We are proud to offer our excellent service at competitive rates, and invite you to discuss your individual requirements.

Examples Include:

- Day Delegate rate **from £29.50**
- 24 Hour Delegate in a single occupancy room with working lunch and three course dinner **from £95.00**
All offers subject to availability

Also available:

- Use of Fully Equipped Gymnasium
- 18-hole Golf Course/16 Bay Driving Range & Practice Putting Green.
- Overnight Accommodation
- Full English or Continental Breakfast



Draycote Hotel & Whitefields Golf Course
London Road, Thurlaston, Nr Rugby, Warwickshire CV23 9LF
Tel: 01788 521800 Fax: 01788 521695
Email: mail@draycotehotel.co.uk www.draycotehotel.co.uk

01788 521800

The Phoenix Suite

Situated on the ground floor, the purpose built Phoenix is a self contained contemporary suite which can be sub-divided into 2 or 3 rooms offering great flexibility. This adaptability makes the Phoenix suite ideal for large conferences, product launches, award dinners, team building exercises, dinner dances, presentation evenings and special events.

Guests can also benefit from easy access to the web via wireless internet installed throughout the entire hotel, which also benefits from air conditioning throughout.

- Air Conditioned Room
- Wi-Fi Internet Access
- Natural Light
- Ground Floor Access
- Separate Bar Area
- Hardwood Dance Floor Area
- Designated Separate Toilets
- Optional Separator Sliding Screens

THE PHOENIX SUITE

Dimensions

Length 32m (approx 102ft) x Width 11m (approx 35ft)

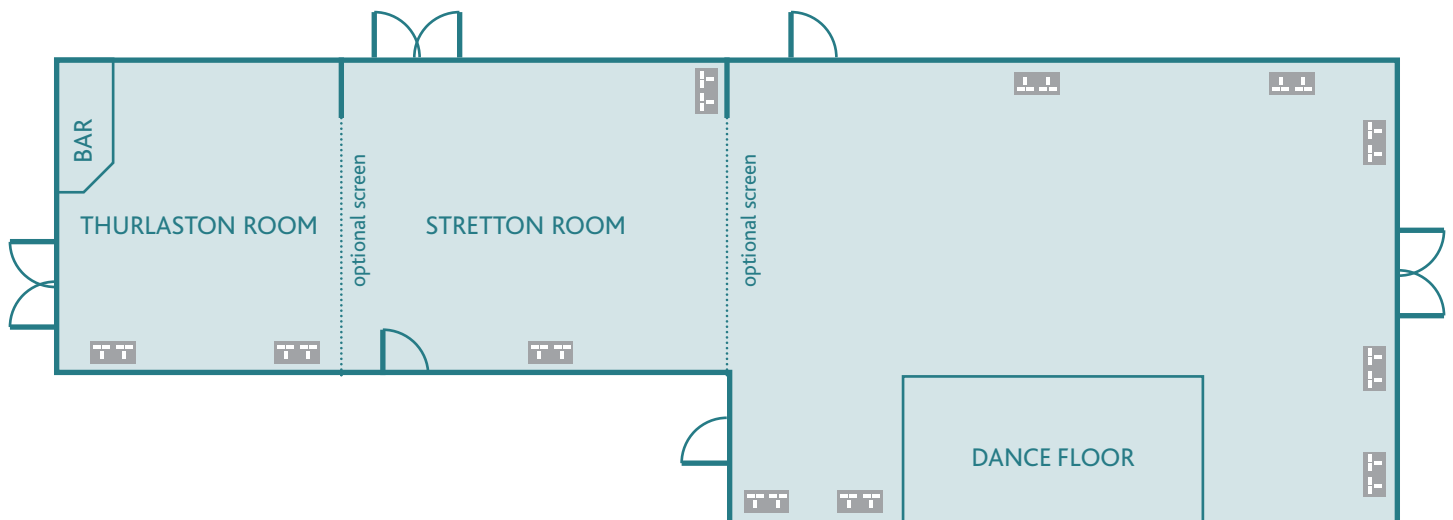

Room Floor Plan Key



Theatre

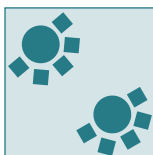

Cabaret

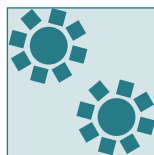

Banquet

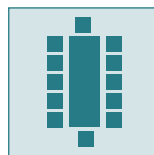

Boardroom

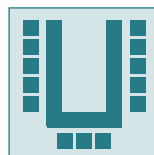

U-shape



Classroom

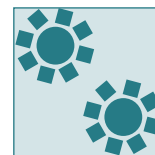

Dinner/Dance

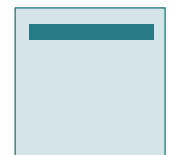

Reception



Draycote Hotel & Whitefields Golf Course
London Road, Thurlaston, Nr Rugby, Warwickshire CV23 9LF
Tel: 01788 521800 Fax: 01788 521695
Email: mail@draycotehotel.co.uk www.draycotehotel.co.uk

01788 521800

The Dunchurch & Dunsmore Rooms

These executive rooms offer complete flexibility and are housed on the first floor overlooking the putting green.

Guests also benefit from easy access to the internet via our wireless network, installed through out the hotel, these suites are also air conditioned.

- Air Conditioned Room
- Wi-Fi Internet Access
- Natural Light
- First Floor Access
- Tea & Coffee Making Facilities
- Projector, Screen and Television
- Optional Laptop Projector

THE DUNCHURCH ROOM

Dimensions

Length 11m (approx 35ft) x Width 9.6m (approx 30ft)

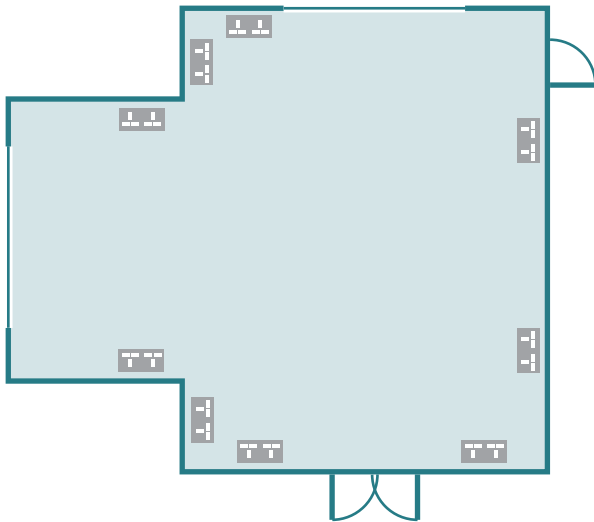

THE DUNSMORE ROOM

Dimensions

Length 10.5m (approx 33ft) x Width 7m (approx 22ft)

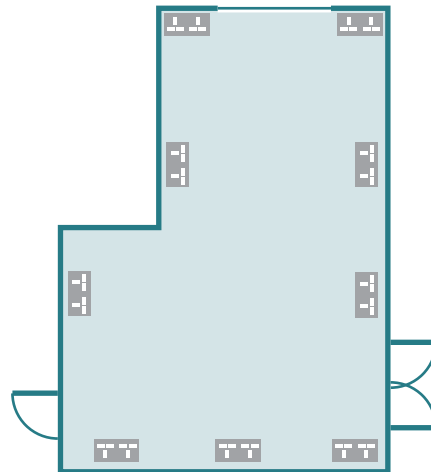

Draycote Hotel & Whitefields Golf Course
London Road, Thurlaston, Nr Rugby, Warwickshire CV23 9LF
Tel: 01788 521800 Fax: 01788 521695
Email: mail@draycotehotel.co.uk www.draycotehotel.co.uk

01788 521800

The Papaveri Suite

The Papaveri Suite is situated on the ground floor of the hotel, with lots of natural daylight; this bright, adaptable room gives a fresh feel to meetings with a touch of class.

It can also be used for private dining, offering an exciting choice of cuisine in calm yet inspired atmosphere. It is the perfect destination to meet, relax and dine.

- Air Conditioned Room
- Wi-Fi Internet Access
- Natural Light
- Ground Floor Access
- Tea & Coffee Making Facilities

Dimensions

Length 10.5m (approx 33ft) x Width 10.6m (approx 32ft)

| ROOM SPECIFICATIONS | THEATRE | CABARET | BANQUET | BOARD ROOM | U-SHAPE | CLASS ROOM | DINNER DANCE | RECEPTION |
|---------------------|---------|---------|---------|------------|---------|------------|--------------|-----------|
| PHOENIX SUITE | 250 | 105 | 180 | 60 | 50 | 120 | 180 | 300 |
| STRETTON ROOM | 50 | 35 | N/A | 20 | 24 | 40 | N/A | 80 |
| THURLASTON ROOM | 15 | 7 | N/A | 8 | N/A | 10 | N/A | 20 |
| DUNCHURCH ROOM | 60 | *35 | 30 | 28 | 20 | 20 | N/A | 60 |
| DUNSMORE ROOM | 20 | *25 | 25 | 22 | 12 | 15 | N/A | 45 |
| PAPVERI SUITE | 60 | 40 | 60 | 30 | 30 | 24 | N/A | 60 |



Draycote Hotel & Whitefields Golf Course
London Road, Thurlaston, Nr Rugby, Warwickshire CV23 9LF
Tel: 01788 521800 Fax: 01788 521695
Email: mail@draycotehotel.co.uk www.draycotehotel.co.uk

01788 521800

Lunch Options

The Working Lunch from £10.95 per person

- Assorted Sandwiches.
- Quiche.
- Breaded Chicken Drumsticks.
- Yellow Fin Sole Goujons in a Sea Salt and Black Pepper Crumb.
- Mini Cocktail Sausages With a Mint and Yoghurt Dip.
- Cheese and Tomato Pizza Wedges.
- Fresh Fruit.

Healthy Eating Buffet Menu from £12.95 per person

- Dry roasted Chilli Seasoned Potato Wedges.
- Vegetable Crudités with a selection of Reduced Fat Dressings and Dips.
- Lime and Coriander Marinated Chicken Skewers.
- Mini Falafel with Turmeric and Yogurt.
- Oven baked Thai Style Marinated Fish Brochettes.
- Fresh Fruit.

Executive Buffet Lunch from £15.95 per person

- Charcuterie - Selection of Local and Continental Meats.
- Oak Smoked Salmon Served with Lime and Wholegrain Mustard Crème Fraiche.
- Sweet Chicken Chilli Kebabs with Mango Salsa.
- Breaded Sticks of Mozzarella.
- Montary Jack Cheese and Onion Goujons.
- Lamb Samosa's with a Pear Relish.
- Lemongrass and Coriander Scented King Prawns.
- Red onion Marmalade and Goats Cheese Savory Tartlet.
- Green Salad.
- Individual Cheese Cakes.

We are happy to shape our menus to your taste.

For further details or to make a booking please contact our Conference Co-ordinator: 01788 521800 (option 4)

Additions

We tailor our packages to meet your requirements and your budget.

In addition to your Day Delegate rate of £26.00 and lunch (£10.95 to £15.95) please choose from the following:

Tea/Coffee £1.95

Tea/Coffee & Biscuits £2.45

Tea/Coffee & Pastries £3.25

The following equipment is available and included in your Day Delegate rate:

- Flip chart & paper
- Overhead projector
- TV & Video / DVD
- Broadband Internet



Draycote Hotel & Whitefields Golf Course
London Road, Thurlaston, Nr Rugby, Warwickshire CV23 9LF
Tel: 01788 521800 Fax: 01788 521695
Email: mail@draycotehotel.co.uk www.draycotehotel.co.uk

01788 521800